

A photograph of a wine cellar interior. The shelves are made of light-colored wood and are filled with wine bottles. The lighting is dramatic, with strong highlights on the shelves and bottles, and deep shadows in the background. The overall atmosphere is sophisticated and elegant.

DUNAVOX
THE WINE COOLING EXPERT

EN

2020

MORE THAN
40
COUNTRIES AROUND THE WORLD

MORE THAN
100
MODELS

3
CATEGORY TYPE



Founded almost twenty years ago out of a passion for wine and wine drinking culture, Dunavox is committed to providing professional storage and cooling solutions for wines stored at home. This dedication has made the Dunavox group one of the markets fastest growing wine cooler companies; currently offering Europe's largest range of units with nearly 50 different models. Dunavox is a brand of minimalistic and functional design character, practical internal layout, state-of-the-art technology and energy efficient performance - which is known and loved in more than 40 countries around the world. Dunavox subsidiaries and distribution network provide high quality assistance, technical support and after-sales service.



Product photos are illustrations. Models sold may be different. Dunavox reserves the right to change parameters without prior notice.

WINE CULTURE

Mankind have been producing wine for more than 7000 years. The Legends says the first grapevine sprouted from Eden, and Noah made the first jug of wine from it. Other myths say Dionysus, the God of wine gave the first grapevine to the people. That's how wine has become the treasure of mankind

The cultivation of grapes and wine-making originates from Caucasian regions which has been proven by archaeological surveys. Wine was the second discovered beverage after water to ease the thirst, meaning that it was the first alcoholic beverage of the European civilization.

Over thousands of years, wine was becoming the part of the European culture and was being consumed in almost every occasion. For example; holidays, dinner parties with friends or family is unimaginable without a good glass of wine.

Nowadays choosing the right wine for a meal is a simple thing, we can choose from a large variety in supermarkets or dedicated wine shops. There are plenty of activities around wine such as wine tasting events, festivals, gourmet events, and even vineyard tours in famous wine producing regions. The wine market is continually growing and in 2019, wine lovers spent more than ever on wine and associated products.



WHY DO I NEED A WINE COOLER?

A wine cooler is designed to mimic a wine cellar, the features that occur naturally in a wine cellar are all managed and maintained within a wine cooler. There is a balance of light, temperature and humidity, where the wine collection can be stored in peace. Wine cellars are difficult to incorporate into existing houses and are generally found in the basement, this means a wine cooler is the perfect solution to store all your wine safely and for many years to come.

— *Own a wine cellar at home ...* —

A DUNAVOX WINE COOLER PROVIDES THE FOLLOWING CONDITIONS FOR YOUR WINES.



Constant temperature

There is a huge variety of grapes available on the market to produce wine from which can be soft, crisp, fruity, light, medium or heavy-bodied – all of which produce a unique set of flavours which develop over a number of years. The temperature influences the taste of the wine, a Dunavox wine cooler can be set manage the temperature inside the cooler to ensure your wines are served at the ideal temperature:

- Champagne 6-8 °C
- Light-bodied white wine 8-10°C
- Rosé 9-12 °C
- Medium/heavy-bodied white wine 10-12 °C
- Light-bodied red wine 12-14 °C
- Medium/heavy bodied red wine 14-18 °C
- Dessert wine 6-8 °C

A single temperature zone cooler are usually used as storage cabinets for wine that will be kept for a few years, the ideal temperature is between 12-14°C. A dual or three zone Dunavox wine cooler offers the possibility to store different kind of wines in the same cooler at the same time, giving you the option to store your wines and serve them at their correct temperatures.



UV light protection

UV light can interfere with the ageing process which will mean the wine will not develop correctly. The doors of Dunavox wine coolers are fully UV protected to ensure there is not UV damage to your wines..



Vibration free storing

Vibration can cause the wine to separate into layers which is why the compressor on a Dunavox cooler is installed with vibration damper technology – removing any unnecessary vibrations that may damage the wine. This solution let the bottles rest in the cooler during the cooling period.



Bottle loading

The bottles should be stored in the horizontal position to ensure the cork is in contact with the wine inside, this ensures the cork does not dry out from the inside. A Dunavox wine cooler will feature solid wooden or metal shelves to allow the wine bottles to chill in peace.



Humidity

The ideal humidity to store wine in is between 50 and 80%, if the humidity falls too low the cork can dry out and if the humidity is too high, mould will thrive inside the wine cooler. A Dunavox unit will maintain the humidity to between the recommended storage range ensuring the cork stays moist, but not too moist.





Dunavox's wine coolers are high quality, market leading products which have been developed and tested for long periods to make sure they meet the market demands of a wine enthusiast. The designs follow the current trends, allowing the wine cooler to become a design feature in any kitchen, restaurant or hotel. Our integrated units are designed to match the European standard sizes with them having a niche width of 59.5cm and a wide range of sizes ranging from 45cm to 178.5cm in height. The undercounter models are available in standard kitchen cabinet widths such as 15cm, 30cm, 40cm and 60cm. All of the Dunavox coolers are available with stainless steel or tinted glass, UV treated doors.

DUNAVOX OFFERS PREMIUM SOLUTIONS FOR PROFESSIONAL WINE STORING

PUSH-TO-OPEN TECHNOLOGY

With the new trend in handleless kitchens, Dunavox have developed wine coolers that feature push-to-open technology. The doors are handleless, a gentle push to the top of the door is enough to activate the internal sensor which opens automatically – ensuring the appliance perfectly matches with all handleless kitchens in a modern design. All of the doors close automatically if the door isn't opened within a few seconds to ensure the temperature is maintained in the cooler.

INTEGRATED VENTILATION SYSTEMS

Our newest development is self-ventilating wine coolers. This makes the wine coolers extremely easy to install as the vents usually required to create the airflow are no longer needed. There is a ventilation grille at the bottom of the cooler which allows the cool air to reach the compressor, at the top there is another ventilation grill which allows the warm air to escape. This means that integrated units can now be installed underneath worktops making them extremely easy to incorporate into modern kitchens.

SINGLE, DUAL AND THREE TEMPERATURE ZONES

Dunavox wine coolers are available with one, two, or three cooling zones. The variety of the product range provides the possibility to store different kinds of wine at their ideal serving or storage temperature – making them versatile, quiet and reliable.

DISPLAY

The new Dunavox models feature either LED displays with touch controls or LCD displays with multicoloured internal lighting to ensure the wine cooler fits into any kitchen design.



**KITCHEN INTEGRATED
WINE COOLER**

NEW

DAV-18.46B.TO



PUSH TO OPEN



DAV-18.46W.TO

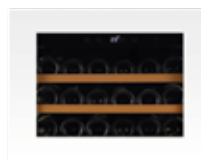

DAV-18.46SS.TO



DAV-18.46

A single zone, 18 bottle integrated model featuring integrated ventilation. Its elegant appearance, handleless design with push2open technology is ideal for any modern kitchen. The tinted glass door can be opened by pushing the corners of the door to allow access to the bottles are displayed on solid beech wood shelves and surrounded by blue interior LED lighting. Please note that this model is an integrated unit designed to be built in or installed undercounter, and is not intended as a freestanding wine cooler.

- 18 Bordeaux bottles
- 1 temperature zone
- Colours: Black, white, stainless steel
- Reversible tinted glass door (UV treated)
- Automatic defrosting
- Integrated ventilation system
- Fan assisted cooling
- Wooden shelves
- Blue interior LED lighting
- Dimensions: (HxWxD): 455 x 590 x 563mm
- 3 years warranty

3

YEARS WARRANTY



Installation guide

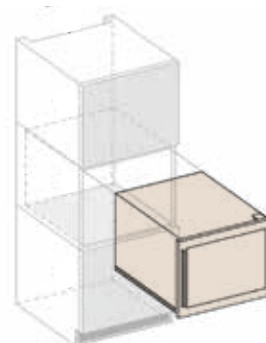



DAB-25.62DB

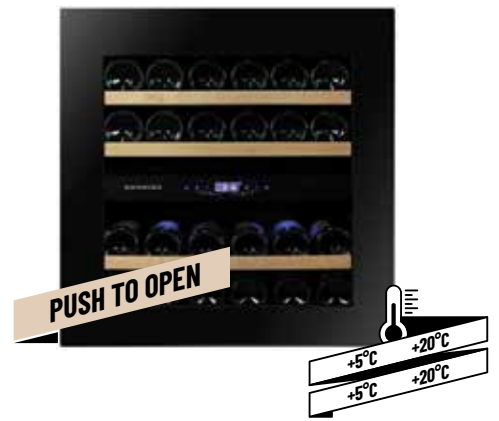

DAB-25.62DW



DAB-25.62DSS



DAB-25.62

A two zone, 25 bottle integrated model featuring integrated ventilation. Its elegant appearance, handleless design with push2open technology is ideal for any modern kitchen. The tinted glass door can be opened by pushing the corners of the door to allow access to the bottles are displayed on solid beech wood shelves and surrounded by blue interior LED lighting. Please note that this model is an integrated unit designed to be built in or installed undercounter, and is not intended as a freestanding wine cooler.

- 25 Bordeaux bottles
- 2 temperature zones
- Colours: Black, white, stainless steel
- Reversible tinted glass door (UV treated)
- Automatic defrosting
- Integrated ventilation system
- Fan assisted cooling
- Wooden shelves
- Blue interior LED light
- Dimensions: (HxWxD): 595 x 590 x 545mm
- 3 years warranty

3
YEARS WARRANTY



Installation guide

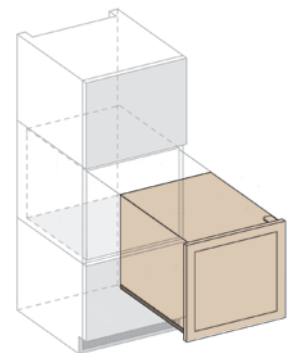



DAB-28.65DB



DAB-28.65DW



DAB-28.65DSS



DAB-28.65

A single zone, 28 bottle integrated wine cooler. Boasting an elegant exterior and a stainless steel door handle, the DAB-28.65 is perfect for contemporary kitchen environments. The bottles are supported on solid wooden shelves set into a light blue interior. Please note that this model is designed to be built in alongside kitchen cabinets and appliances, and is not intended as a freestanding or undercounter wine cooler.

- 28 Bordeaux bottles
- 1 temperature zone
- Colours: Black, white, stainless steel
- Reversible tinted glass door (UV treated)
- Automatic defrosting
- Fan assisted cooling
- Wooden shelves
- Blue interior LED light
- Dimensions (HxWxD): 455 x 590 x 545mm
- 3 years warranty

3
YEARS WARRANTY



Installation guide

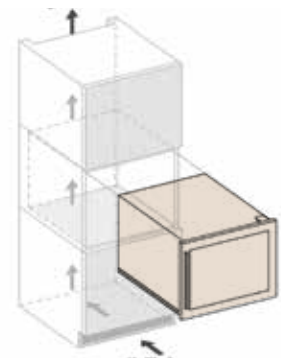



NEW

DAV-32.81DB.TO



DAV-32.81DW.TO



DAV-32.81DSS.TO



DAV-32.81

A two zone, 32 bottle integrated model featuring integrated ventilation. Its elegant appearance, handleless design with push2open technology is ideal for any modern kitchen. The tinted glass door can be opened by pushing the corners of the door to allow access to the bottles are displayed on solid beech wood shelves and surrounded by blue interior LED lighting. Please note that this model is an integrated unit designed to be built in or installed undercounter, and is not intended as a freestanding wine cooler.

- 32 Bordeaux bottles
- 2 temperature zones
- Colours: Black, white, stainless steel
- Reversible tinted glass door (UV treated)
- Automatic defrosting
- Integrated ventilation system
- Fan assisted cooling
- Wooden shelves
- Blue interior LED lighting
- Dimensions: (HxWxD): 715 x 592 x 559cm
- 3 years warranty

3
YEARS WARRANTY



Installation guide

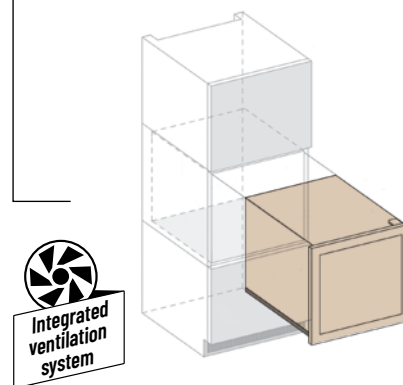



DAB-36.80DB

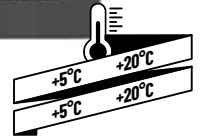

DAB-36.80DW



DAB-36.80DSS



DAB-36.80

A two zone, 36 bottle integrated wine cooler. Boasting an elegant exterior and a stainless steel door handle, the DAB-36.80 is perfect for contemporary kitchen environments. The bottles are supported on solid wooden shelves set into a light blue interior. Please note that this model is designed to be built in alongside kitchen cabinets and appliances, and is not intended as a freestanding or undercounter wine cooler.

- 36 Bordeaux bottles
- 2 temperature zones
- Colours: Black, white, stainless steel
- Reversible tinted glass door (UV treated)
- Automatic defrosting
- Fan assisted cooling
- Wooden shelves
- Blue interior LED light
- Dimensions: (HxWxD): 595 x 590 x 563mm
- 3 years warranty

3
YEARS WARRANTY



Installation guide

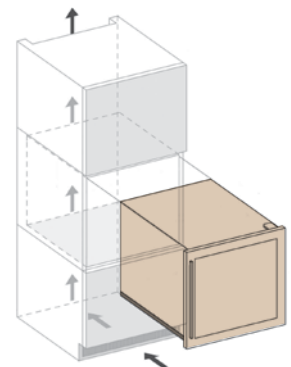



DAB-41.83DB



DAB-41.83DSS



DAB-41.83

A two zone, 41 bottle integrated wine cooler. Boasting an elegant exterior and a stainless steel door handle, the DAB-41.83 is perfect for contemporary kitchen environments. The bottles are supported on solid wooden shelves set into a light blue interior. Please note that this model is designed to be built in alongside kitchen cabinets and appliances, and is not intended as a freestanding or undercounter wine cooler.

- 41 Bordeaux bottles
- 2 temperature zones
- Colours: Black, stainless steel
- Reversible tinted glass door (UV treated)
- Automatic defrosting
- Fan assisted cooling
- Wooden shelves
- Blue interior LED light
- Dimensions: (HxWxD): 595 x 590 x 556mm
- 3 years warranty

3
YEARS WARRANTY



Installation guide

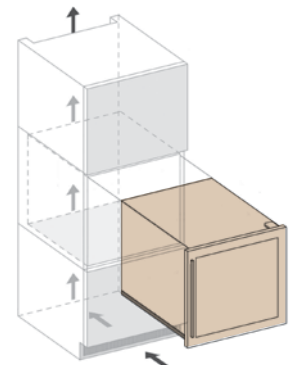



DAB-42.117DB



DAB-42.117DSS



DAB-42.117

A two zone, 42 bottle integrated wine cooler. Boasting an elegant exterior and a stainless steel door handle, the DAB-42.117 is perfect for contemporary kitchen environments. The bottles are supported on solid wooden shelves set into a light blue interior. Please note that this model is designed to be built in alongside kitchen cabinets and appliances, and is not intended as a freestanding or undercounter wine cooler.

- 42 Bordeaux bottles
- 2 temperature zones
- Colours: Black, stainless steel
- Reversible tinted glass door (UV treated)
- Automatic defrosting
- Fan assisted cooling
- Wooden shelves
- Blue interior LED light
- Dimensions: (HxWxD): 885 x 590 x 560mm
- 3 years warranty

3
YEARS WARRANTY



Installation guide

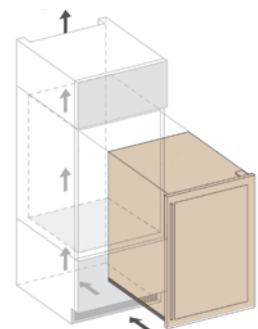



DAB-49.116DB.TO

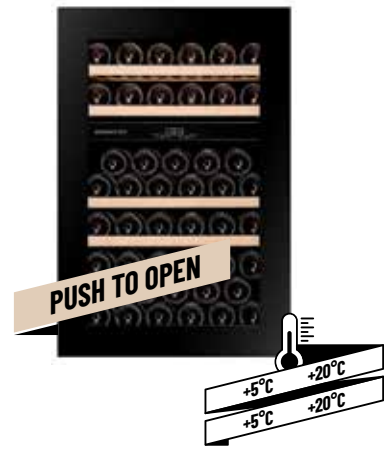

DAB-49.116DSS.TO



DAB-49.116

A two zone, 49 bottle integrated model featuring integrated ventilation. Its elegant appearance, handleless design with push2open technology is ideal for any modern kitchen. The tinted glass door can be opened by pushing the corners of the door to allow access to the bottles are displayed on solid beech wood shelves and surrounded by blue interior LED lighting. Please note that this model is an integrated unit designed to be built in or installed undercounter, and is not intended as a freestanding wine cooler.

- 49 Bordeaux bottles
- 2 temperature zones
- Colours: Black, white, stainless steel
- Reversible tinted glass door (UV treated)
- Automatic defrosting
- Integrated ventilation system
- Fan assisted cooling
- Wooden shelves
- Blue interior LED light
- Dimensions: (HxWxD): 885 x 590 x 545mm
- 3 years warranty

3
YEARS WARRANTY



Installation guide

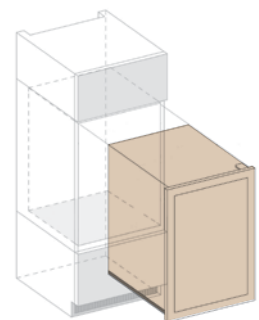



DX-57.146DBK



DX-57.146DWK



DX-57.146DSK



DX-57.146

A two zone, 57 bottle integrated wine cooler. Boasting an elegant exterior and a stainless steel door handle, the DX-57.146 is perfect for contemporary kitchen environments. The bottles are supported on solid wooden shelves set into a light blue interior. Please note that this model is designed to be built in alongside kitchen cabinets and appliances, and is not intended as a freestanding or undercounter wine cooler.

- 57 Bordeaux bottles
- 2 temperature zones
- Colours: Black, white, stainless steel
- Reversible tinted glass door (UV treated)
- Automatic defrosting
- Fan assisted cooling
- Wooden shelves
- Blue interior LED light
- Dimensions: (HxWxD): 885 x 590 x 545mm
- 3 years warranty

3
YEARS WARRANTY



Installation guide

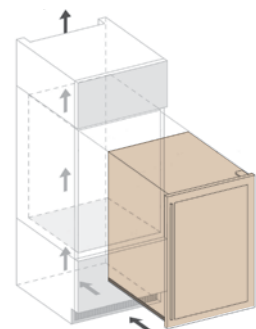



DAB-65.178TB.TO

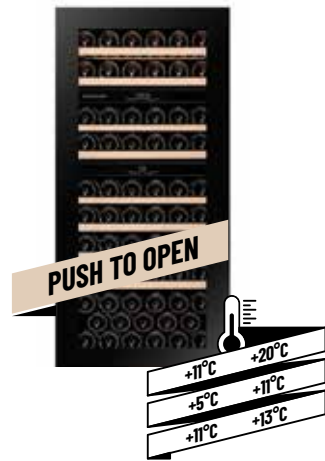

DAB-65.178TW.TO



DAB-65.178TBSS.TO



DAB-65.178

A three zone, 65 bottle integrated model featuring integrated ventilation. Its elegant appearance, handleless design with push2open technology is ideal for any modern kitchen. The tinted glass door can be opened by pushing the corners of the door to allow access to the bottles are displayed on solid beech wood shelves and surrounded by blue interior LED lighting. Please note that this model is an integrated unit designed to be built in or installed undercounter, and is not intended as a freestanding wine cooler.

- 65 Bordeaux bottles
- 3 temperature zones
- Colours: Black, white, stainless steel
- Reversible tinted glass door (UV treated)
- Automatic defrosting
- Integrated ventilation system
- Fan assisted cooling
- Wooden shelves
- Blue interior LED light
- Dimensions: (HxWxD): 1234 x 590 x 545mm
- 3 years warranty

3
YEARS WARRANTY



Installation guide

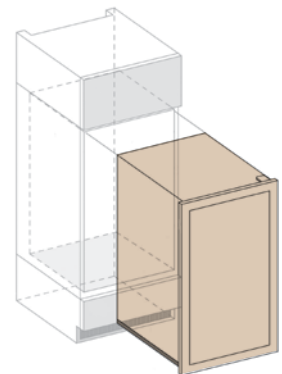

NEW

DX-74.230DBK



DX-74.230DWK



DX-74.230

A two zone, 74 bottle integrated wine cooler. Boasting an elegant exterior and a stainless steel door handle, the DX-74.230 is perfect for contemporary kitchen environments. The bottles are supported on solid wooden shelves set into a light blue interior. Please note that this model is designed to be built in alongside kitchen cabinets and appliances, and is not intended as a freestanding or undercounter wine cooler.

- 74 Bordeaux bottles
- 2 temperature zones
- Colours: Black, white
- Reversible tinted glass door (UV treated)
- Automatic defrosting
- Fan assisted cooling
- Wooden shelves
- Blue interior LED light
- Dimensions: (HxWxD): 1233 x 590 x 570mm
- 3 years warranty

3
YEARS WARRANTY



Installation guide

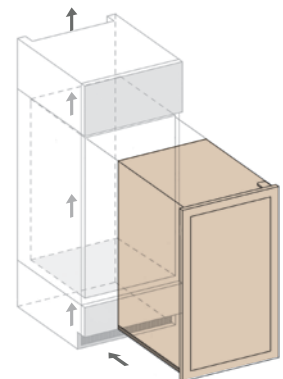



DX-89.246TB



DX-89.246TSS



DX-89.246

A three zone, 89 bottle integrated wine cooler. Boasting an elegant exterior and a stainless steel door handle, the DX-89.246 is perfect for contemporary kitchen environments. The bottles are supported on solid wooden shelves set into a light blue interior. Please note that this model is designed to be built in alongside kitchen cabinets and appliances, and is not intended as a freestanding or undercounter wine cooler.

- 89 Bordeaux bottles
- 3 temperature zones
- Colours: Black, stainless steel
- Reversible tinted glass door (UV treated)
- Automatic defrosting
- Fan assisted cooling
- Wooden shelves
- Blue interior LED light
- Dimensions: (HxWxD): 1788 x 587 x 557mm
- 3 years warranty

3
YEARS WARRANTY



Installation guide

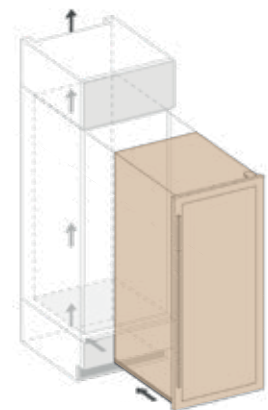



DAB-89.215DB



DAB-89.215DW



DAB-89.215DSS



DAB-89.215

A two zone, 89 bottle integrated wine cooler. Boasting an elegant exterior and a stainless steel door handle, the DAB-89.215 is perfect for contemporary kitchen environments. The bottles are supported on solid wooden shelves set into a light blue interior. Please note that this model is designed to be built in alongside kitchen cabinets and appliances, and is not intended as a freestanding or undercounter wine cooler.

- 89 Bordeaux bottles
- 2 temperature zones
- Colours: Black, white, stainless steel
- Reversible tinted glass door (UV treated)
- Automatic defrosting
- Fan assisted cooling
- Wooden shelves
- Blue interior LED light
- Dimensions: (HxWxD): 1234 x 590 x 563mm
- 3 years warranty

3
YEARS WARRANTY



Installation guide

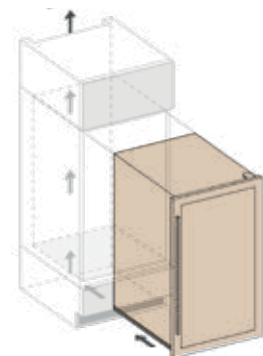



DAB-114.288DB.TO

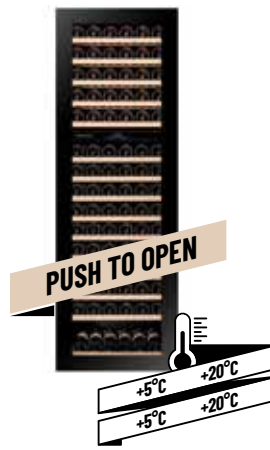

DAB-114.288DW.TO



DAB-114.288DSS.TO



DAB-114.288

A two zone, 114 bottle integrated model featuring integrated ventilation. Its elegant appearance, handleless design with push2open technology is ideal for any modern kitchen. The tinted glass door can be opened by pushing the corners of the door to allow access to the bottles are displayed on solid beech wood shelves and surrounded by blue interior LED lighting. Please note that this model is an integrated unit designed to be built in or installed undercounter and is not intended as a freestanding wine cooler.

- 114 Bordeaux bottles
- 2 temperature zones
- Colours: Black, white, stainless steel
- Reversible tinted glass door (UV treated)
- Automatic defrosting
- Integrated ventilation system
- Fan assisted cooling
- Wooden shelves
- Blue interior LED light
- Dimensions: (HxWxD):1784 x 590 x 545mm
- 3 years warranty



Installation guide

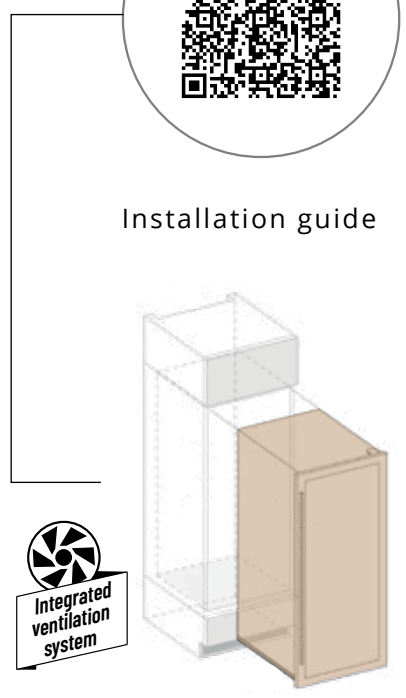

PREMIUM DUNAVOX SOLUTIONS

Dunavox has a wide variety of undercounter models that feature LED or LCD displays, different lighting options and all are available in black or stainless steel and some models in white. The control panels are user friendly and allow you to set the temperature precisely and quickly as well as turning the lighting on and off. All of the Dunavox undercounter models feature reversible doors to ensure the door swing matches kitchen cabinets or if there is a wall stopping the wine cooler from opening.

The ventilation grille at the bottom of the wine cooler is removable and should be removed if you plan to run a plinth in front of the wine cooler – if doing so, you must ensure there is enough vents cut into the plinth to allow the wine cooler to breathe correctly. Behind the grille there are a series of fans which draw in cool air to cool the compressor and expel warm air, if you don't incorporate the ventilation into the plinth the cooling ability will be limited and the wine cooler may overheat.

Our undercounter wine coolers are manufactured to standard sizes and are available in widths to match normal kitchen cabinets, such as: 150mm, 300mm, 400mm and 600mm. The bottle capacities vary depending on the size of the wine cooler but you can find our units with capacities ranging from 7 to 46 bottles in the undercounter units. The standard height is 820mm to match the standard door height of a kitchen but we also have handleless models that can be used undercounter that match German handleless kitchen countertop heights of 885-890mm to create a seamless finish.

Dunavox manufactures both single and dual temperature zone units for the built in models which can be used for storage of your fine wines at 12°C, or the dual zone models are very versatile and allow you to store both reds or whites at their ideal serving temperatures. The upper zone is generally the cooler zone as most of our units incorporate an integrated heater which is used to raise the internal temperature of the lower section.



KITCHEN UNDERCOUNTER WINE COOLER



DX-7.20BK/DP



DX-7.20WK/DP



DX-7.20SSK/DP



DX-7.20

A single zone, 7 bottle undercounter model. The DX-7.20 is perfect for modern kitchens with its elegant exterior and stainless steel door handle. The bottles are supported on fixed shelves set into a stunning light blue interior. Please note that this model is intended as a built in undercounter unit.

- 7 Bordeaux bottles
- 1 temperature zone
- Colours: Black, white, stainless steel
- Reversible tinted glass door (UV treated)
- Automatic defrosting
- Fan assisted cooling
- Blue interior LED light
- Dimensions: (HxWxD): 825 x 148 x 525mm
- 3 years warranty

3
YEARS WARRANTY



Installation guide

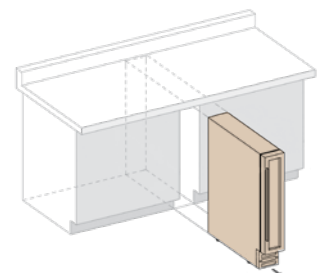

NEW

DAU-9.22B



DAU-9.22W



DAU-9.22SS



DAU-9.22

A redesign of the DX-7.20 small compressor unit, now featuring a larger capacity of 9 Bordeaux bottles. Available in black, white and stainless steel – this model is ideal for modern kitchens with limited space. The bottles are supported on fixed shelves set into a stunning light blue interior. Please note that this model is intended as a built in undercounter unit.

- 9 Bordeaux bottles
- 1 temperature zone
- Colours: Black, white, stainless steel
- Reversible tinted glass door (UV treated)
- Automatic defrosting
- Fan assisted cooling
- Wooden slats
- White interior LED lighting
- Dimensions: (HxWxD): 820 x 150 x 525mm
- 3 years warranty

3

YEARS WARRANTY



Installation guide

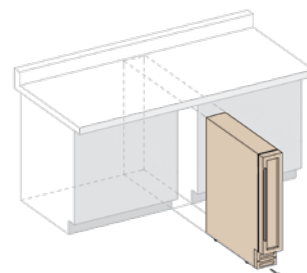



DAU-17.57DB



DAU-17.57DW



DAU-17.57DSS



DAU-17.57

A dual temperature zone, 17 bottle undercounter model, boasting an elegant exterior and a stainless steel door handle. The DAU-17.57 is perfect for contemporary kitchen environments. Bottles are supported on solid wooden shelves set into a stunning light blue interior. Please note that this model is intended as a built in undercounter unit.

- 17 Bordeaux bottles
- 2 temperature zone
- Colours: Black, white, stainless steel
- Reversible tinted glass door (UV treated)
- Automatic defrosting
- Fan assisted cooling
- Wooden shelves
- Blue interior LED lighting
- Dimensions: (HxWxD): 820 x 295 x 570mm
- 3 years warranty

3
YEARS WARRANTY



Installation guide

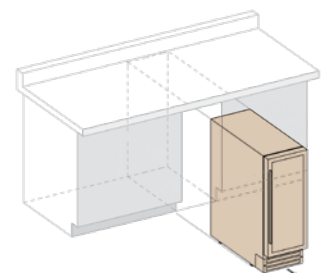



DAU-17.58DB



DAU-17.58DW



DAU-17.58DSS



DAU-17.58

A dual temperature zone, 17 bottle undercounter model, boasting an elegant exterior and a stainless steel door handle. The DAU-17.58 is perfect for contemporary kitchen environments. Bottles are supported on solid wooden shelves set into a stunning light blue interior. Please note that this model is intended as a built in undercounter unit.

- 17 Bordeaux bottles
- 2 temperature zones
- Colours: Black, white, stainless steel
- Reversible tinted glass door (UV treated)
- Automatic defrosting
- Fan assisted cooling
- Wooden shelves
- Blue interior LED lighting
- Dimensions: (HxWxD): 820 x 295 x 570mm
- 3 years warranty

3
YEARS WARRANTY



Installation guide

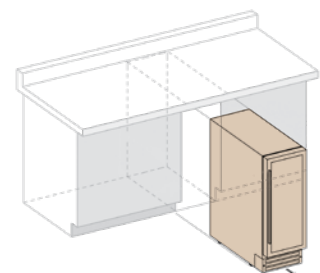



DAU-19.58B



DAU-19.58W



DAU-19.58SS



DAU-19.58

A single temperature zone, 19 bottle undercounter model, boasting an elegant exterior and a stainless steel door handle. The DAU-19.58 is perfect for contemporary kitchen environments. Bottles are supported on solid wooden shelves set into a stunning light blue interior. Please note that this model is intended as a built in undercounter unit.

- 19 Bordeaux bottles
- 1 temperature zone: +5 to +20°C
- Colours: Black, white, stainless steel
- Reversible tinted glass door (UV treated)
- Automatic defrosting
- Fan assisted cooling
- Wooden shelves
- Blue internal LED lighting
- Dimensions: (HxWxD): 820 x 295 x 570mm
- 3 years warranty

3
YEARS WARRANTY



Installation guide

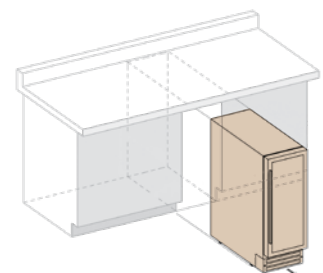



DAU-32.78DB



DAU-32.78DW



DAU-32.78DSS



DAU-32.78

A dual temperature zone, 32 bottle undercounter model, boasting an elegant exterior and a stainless steel door handle. The DAU-32.78 is perfect for contemporary kitchen environments. Bottles are supported on solid wooden shelves set into a stunning light blue interior. Please note that this model is intended as a built in undercounter unit.

- 32 Bordeaux bottles
- 2 temperature zones
- Colours: Black, white, stainless steel
- Reversible tinted glass door (UV treated)
- Automatic defrosting
- Fan assisted cooling
- Wooden shelves
- Blue interior LED lighting
- Dimensions: (HxWxD): 820 x 380 x 563mm
- 3 years warranty

3
YEARS WARRANTY



Installation guide

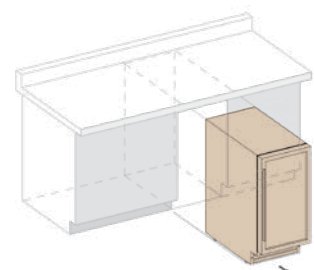



DAU-32.83B



DAU-32.83W



DAU-32.83SS



DAU-32.83

A single temperature zone, 32 bottle undercounter model, boasting an elegant exterior and a stainless steel door handle. The DAU-32.83 is perfect for contemporary kitchen environments. Bottles are supported on solid wooden shelves set into a stunning light blue interior. Please note that this model is intended as a built in undercounter unit.

- 32 Bordeaux bottles
- 1 temperature zone
- Colours: Black, white, stainless steel
- Reversible tinted glass door (UV treated)
- Automatic defrosting
- Fan assisted cooling
- Wooden shelves
- Blue interior LED lighting
- Dimensions: (HxWxD): 820 x 380 x 563mm
- 3 years warranty

3
YEARS WARRANTY



Installation guide

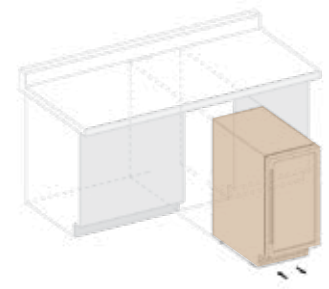



NEW

DAU-39.121DB



DAU-39.121DW



DAU-39.121.DSS



DAU-39.121

A two zone, 39 bottle undercounter model. It's a re-designed version of one of the most popular undercounter model. Boasting an elegant exterior and a stainless steel door handle. The DAU-39.121 is perfect for contemporary kitchen environments. Bottles are supported on solid wooden shelves set into a stunning LED lit interior. Please note that this model is intended as a built in undercounter unit.

- 39 Bordeaux bottles
- 2 temperature zones
- Colours: Black, white, stainless steel
- Reversible tinted glass door (UV treated)
- Automatic defrosting
- Active charcoal filter
- Fan assisted cooling
- Wooden shelves - telescopic
- White, orange and blue LED lighting
- Dimensions: (HxWxD): 820 x 595 x 562mm
- 3 years warranty

3

YEARS WARRANTY



Installation guide

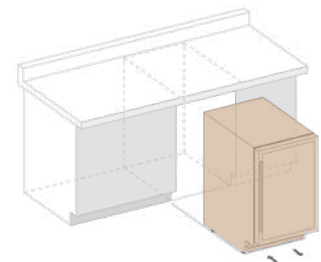



DAU-40.138B



DAU-40.138SS

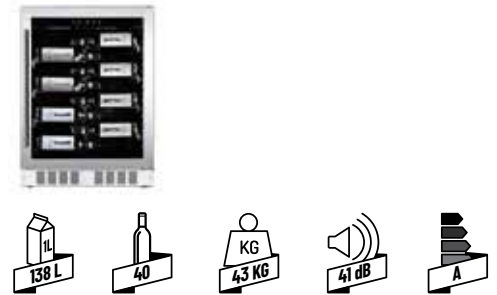

DAU-40.138

A single zone, 40 bottle undercounter model. Boasting an elegant exterior and a stainless steel door handle. The DAU-40.138 is perfect for contemporary kitchen environments. Bottles are supported on patent display shelves set into a stunning light white interior. Please note that this model is intended as a built-in undercounter model.

- 40 Bordeaux bottles
- 1 temperature zone
- Colours: Black, stainless steel
- Reversible tinted glass door (UV treated)
- Automatic defrosting
- Fan assisted cooling
- Telescopic display shelves
- Interior white LED light
- Dimensions: (HxWxD): 813 x 595 x 570mm
- 3 years warranty

3
YEARS WARRANTY



Installation guide

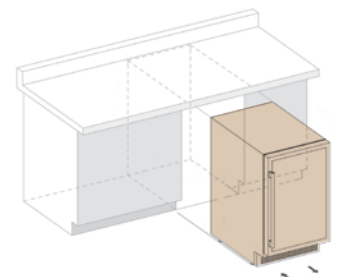



DAU-45.125DB.TO



DAU-45.125DW.TO



DAU-45.125DSS.TO



DAU-45.125

A two zone, 45 bottle undercounter model featuring handleless design and push to open technology. The door is opened by pushing the door which is also self-closing. The DAU-45.125 is perfect for contemporary kitchen environments. Bottles are supported solid beech wood shelves set into a stunning light blue interior. Please note that this model is intended as a built in undercounter model.

- 45 Bordeaux bottles
- 2 temperature zones
- Colours: Black, white, stainless steel
- Reversible tinted glass door (UV treated)
- Automatic defrosting
- Fan assisted cooling
- Wooden shelves
- Blue interior LED light
- Dimensions: (HxWxD): 880 x 595 x 577mm
- 3 years warranty

3
YEARS WARRANTY



Installation guide

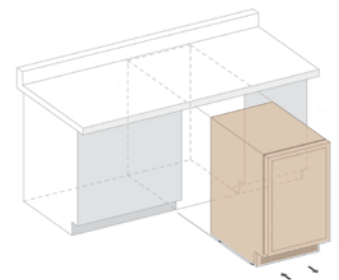



NEW

DAU-46.138B



DAU-46.138W



DAU-46.138SS



DAU-46.138

A single zone, 46 bottle undercounter model. It's a redesigned version of one of the most popular undercounter model. Boasting an elegant exterior and a stainless steel door handle. The DAU-46.138 is perfect for contemporary kitchen environments. Bottles are supported on solid wooden shelves set into a stunning light blue interior. Please note that this model is intended as a built-in undercounter model.

- 46 Bordeaux bottles
- 1 temperature zone: +5 to +18°C
- Colours: Black, white tinted, stainless steel
- Reversible tinted glass door (UV treated)
- Active charcoal filter
- Automatic defrosting
- Fan assisted cooling
- Wooden shelves - telescopic
- White, blue and orange LED lighting
- Dimensions: (HxWxD): 820 x 595 x 562mm
- 3 years warranty

3
YEARS WARRANTY



Installation guide

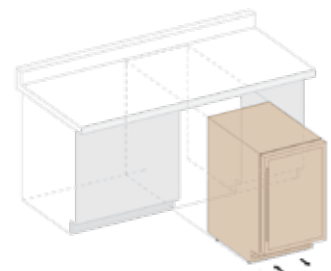



NEW

DAU-46.145DB



DAU-46.145DSS



DAU-46.145

A two zone, 46 bottle undercounter model. Boasting an elegant exterior and LCD display. The DAU-46.145 is perfect for contemporary kitchen environments. The bottles are supported on telescopic rails set into a stunning white interior. Please note that this model is intended as a built in undercounter unit.

- 46 Bordeaux bottles
- 2 temperature zones
- Colours: Black, Stainless steel
- Reversible tinted glass door (UV treated)
- Automatic defrosting
- Fan assisted cooling
- Wooden shelves - telescopic
- White internal LED lighting
- Dimensions: (HxWxD): 820 x 595 x 562mm
- 3 years warranty

3
YEARS WARRANTY



Installation guide

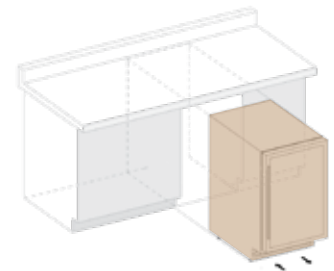

DUNAVOX HORECA LINE

Dunavox also have a range of freestanding units of varying sizes that are suitable for both commercial and domestic environments.

FREESTANDING WINE COOLERS

The smaller compressor line and thermoelectric units are designed with serving temperatures in mind and due to their design, they should not be installed under a counter top or built in at all. These models have been designed with minimalist design and are suitable for storing open bottles of wine.

THE EXCLUSIVE LINE

The exclusive line is a range of wine coolers that is suitable for both built in and freestanding installation, designed to look aesthetically pleasing while ensuring your wines are kept at the ideal temperatures for storage and serving of that particular wine. With a wide operating temperature of between 5°C and 22°C and the option to have 1, 2 or 3 temperature zones – there is an extensive range of options available to meet your wine storage requirements.

THE HORECA RANGE

The Dunavox Horeca line is ideal for restaurants, hotels and bars – they are very robust and designed to store bottles both upright and, on their sides whilst creating a visual display with the vivid blue lighting. These units are designed to be freestanding which does mean there needs to be some ventilation space around them.





**FREESTANDING
WINE COOLERS**



DX-16.46

A single zone, 16 bottle model. The smallest freestanding model with a recessed door handle. Bottles are supported on solid wooden shelves. This cooler supports the storage of opened bottles. This unit isn't suitable to be built in or under a counter.

- 16 Bordeaux bottles
- 1 temperature zone
- Colour: Black, tinted glass door (UV treated)
- Automatic defrosting
- Wooden shelves
- Direct cooling - no fans
- Blue interior LED lighting
- Dimensions: (HxWxD): 510 x 430 x 480mm
- 3 years warranty

DX-16.46K





DX-20.62

A single zone, 20 bottle model. The cooler has a recessed door handle and the bottles are supported on solid wooden shelves. This cooler supports the storage of open bottles. This unit isn't suitable to be built in or under a counter.

- 20 Bordeaux bottles
- 1 temperature zone
- Colour: Black, tinted glass door (UV treated)
- Wooden shelves
- Direct cooling – no fans
- Blue interior LED light
- Dimensions: (HxWxD): 650 x 430 x 480mm
- 3 years warranty

DX-20.62KF





DX-28.88

A single zone, 28 bottle model. The cooler has a recessed door handle. Bottles are supported on solid wooden shelves. This cooler supports the storage of open bottles. This unit isn't suitable to be built in or under a counter.

- 28 Bordeaux bottles
- 1 temperature zone
- Colour: Black, tinted glass door (UV Treated)
- Wooden shelves
- Direct cooling - no fans
- Blue interior LED light
- Dimensions: (HxWxD): 830 x 430 x 480mm
- 3 years warranty

DX-28.88KF





DX-30.80

A two zone, 30 bottle model. The cooler has a recessed door handle and the bottles are supported on solid wooden shelves. This cooler supports the storage of open bottles. This unit isn't suitable to be built in or under a counter.

- 30 Bordeaux bottles
- 2 temperature zones
- Colour: Black, tinted glass door (UV treated)
- Fan assisted cooling
- Wooden shelves
- Blue Interior LED lighting
- Dimensions: (HxWxD): 840 x 480 x 490mm
- 3 years warranty

DX-30.80KF





DX-46.128

A two zone, 46 bottle model. The cooler has a recessed door handle. Bottles are supported on solid wooden shelves. This cooler supports the storage of opened bottles. This unit isn't suitable to be built in or under a counter.

- 46 Bordeaux bottles
- 2 temperature zone
- Colour: Black, tinted glass door (UV treated)
- Fan assisted cooling
- Wooden shelves
- Blue interior LED light
- Dimensions: (HxWxD): 1125 x 550 x 480mm
- 3 years warranty

DX-46.128DK





DX-48.130

A single zone, 48 bottle model. The cooler has a recessed door handle and the bottles are supported on solid wooden shelves. This cooler supports the storage of opened bottles. This unit isn't suitable to be built in or under a counter. This model has a mechanical thermostat making it very reliable.

- 48 Bordeaux bottles
- 1 temperature zone
- Colour: Black, tinted glass door (UV treated)
- Fan assisted cooling
- Wooden shelves
- Blue interior LED light
- Dimensions: (HxWxD): 820 x 480 x 480mm
- 3 years warranty

DX-48.130KF





DX-54.150

A two zone 54 bottle model. The cooler has a recessed door handle and the bottles are supported on solid wooden shelves. This cooler supports the storage of opened bottles. This unit isn't suitable to be built in or under a counter.

- 54 Bordeaux bottles
- 2 temperature zone
- Colour: Black, tinted glass door (UV treated)
- Fan assisted cooling
- Wooden shelves
- Blue interior LED light
- Dimensions: (HxWxD): 1295 x 480 x 480mm
- 3 years warranty

DX-54.150DK





DX-94.270DBK

DX-94.270SDSK



DX-94.270

A two zone, 94 bottle freestanding model from Dunavox's Exclusive range. Boasting an elegant exterior - the SDSK model has a stainless steel handle and the black unit has a recessed handle. The DX-94.270 is perfect for contemporary kitchen environments and the bottles are supported on solid wooden shelves set into a stunning light blue interior. Please note that this model is suitable for freestanding or built in use.

- 94 Bordeaux bottles
- 2 temperature zones
- Colours: Black, stainless steel
- Reversible tinted glass door (UV treated)
- Lock
- Active charcoal filter
- Fan assisted cooling
- Automatic defrosting
- Wooden shelves
- Blue interior LED light
- Dimensions: (HxWxD): 1200 x 595 x 680mm
- 3 years warranty

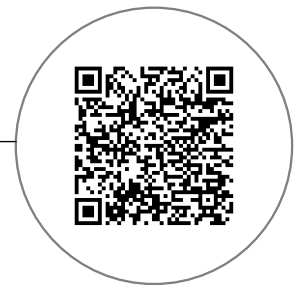

Installation guide

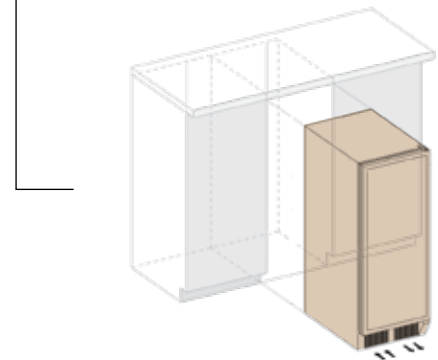



NEW

DX-104.375DB

DX-104.375DSS

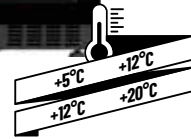

DX-104.375

A two zone, 104 bottle freestanding model from Dunavox's exclusive 'label view' range. Boasting an elegant exterior. The DX-104.375 is perfect for contemporary kitchen environments. Bottles are supported on patent display shelves set into a stunning light blue/red/green interior. Please note that this model is suitable for standalone and built-in use.

- 104 Bordeaux bottles
- 2 temperature zones
- Colours: Black or stainless steel
- Reversible tinted glass door (UV treated)
- Active charcoal filter
- Automatic defrosting
- Fan assisted cooling
- Telescopic display shelves
- Blue/red/green interior LED lighting
- Dimensions: (HxWxD): 1600 x 595 x 700mm
- 3 years warranty

3
YEARS WARRANTY



Installation guide

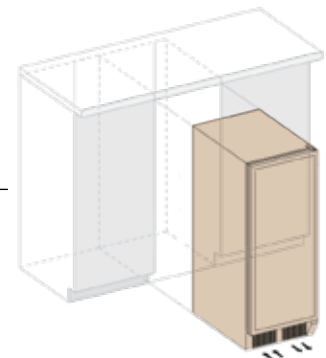



DX-107.229K

A single zone, 107 bottle freestanding model from the Horeca range. The DX-107.229 is perfect for contemporary kitchens or restaurants, hotels and bars. Bottles are supported on solid wooden sapele shelves set into a stunning light blue interior. This unit is suitable for freestanding installation only.

- 107 Bordeaux bottles
- 1 temperature zone
- Colour: Black
- Lock
- Active charcoal filter
- Reversible tinted glass door (UV treated)
- Wooden shelves
- Blue interior LED lighting
- Dimensions: (HxWxD): 1240 x 595 x 615mm
- 3 years warranty

DX-107.229K





DX-143.468B

DX-143.468SS



DX-143.468

A single zone, 143 bottles freestanding model from Duna-vox's Exclusive range. Boasting an elegant exterior - the SS model has a stainless steel handle and the black unit has black handle. DX-143.468 is perfect for contemporary kitchen environments, restaurants or hotels. The bottles are supported on patent display shelves set into a stunning light blue interior. Please note that this model is suitable for freestanding or built in use.

- 143 Bordeaux bottles
- 1 temperature zone
- Colours: Black, stainless steel
- Lock
- Reversible tinted glass door (UV treated)
- Active charcoal filter
- Automatic defrosting
- Fan assisted cooling
- Telescopic display shelves
- Blue interior LED light
- Dimensions: (HxWxD): 1830 x 655 x 680mm
- 3 years warranty

3
YEARS WARRANTY



Installation guide

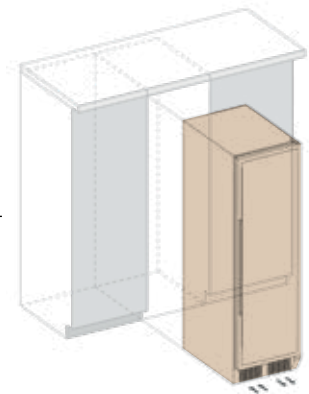



DX-147.280K

DX-147.280K

A single zone, 147 bottles freestanding model from the Horeca range. Boasting an elegant exterior - DX-147.280 is perfect for contemporary kitchens, restaurants or hotels. The bottles are supported on solid sapele shelving and set into a stunning light blue interior. This unit is suitable for freestanding installation only.

- 147 Bordeaux bottles
- 1 temperature zone
- Colour: Black
- Lock
- Reversible tinted glass door (UV treated)
- Active charcoal filter
- Wooden shelves
- Blue interior LED light
- Dimensions: (HxWxD): 1660 x 594 x 560mm
- 3 years warranty





DX-166.428DBK

DX-166.428SDSK

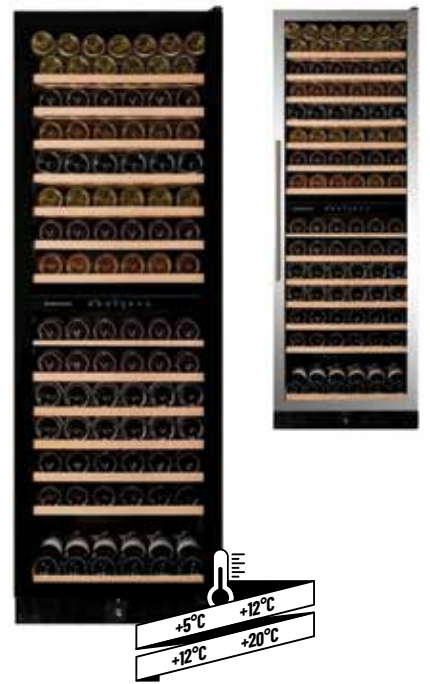

DX-166.428

A two zone, 166 bottle freestanding model from the exclusive line. Boasting an elegant exterior - the DX-166.428 is perfect for contemporary kitchens, bars and hotels. The bottles are supported on wooden shelves set into a stunning light blue interior. Please note that this model is suitable for freestanding or built in use.

- 166 Bordeaux bottles
- 2 temperature zones
- Colours: Black, stainless steel
- Lock
- Reversible tinted glass door (UV treated)
- Active charcoal filter
- Automatic defrosting
- Fan assisted cooling
- Wooden shelves - telescopic
- Blue interior LED light
- Dimensions: (HxWxD): 1770 x 595 x 680mm
- 3 year warranty

3
YEARS WARRANTY



Installation guide

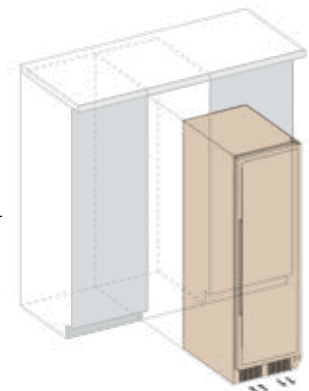



DX-170.490TBK

DX-170.490STSK

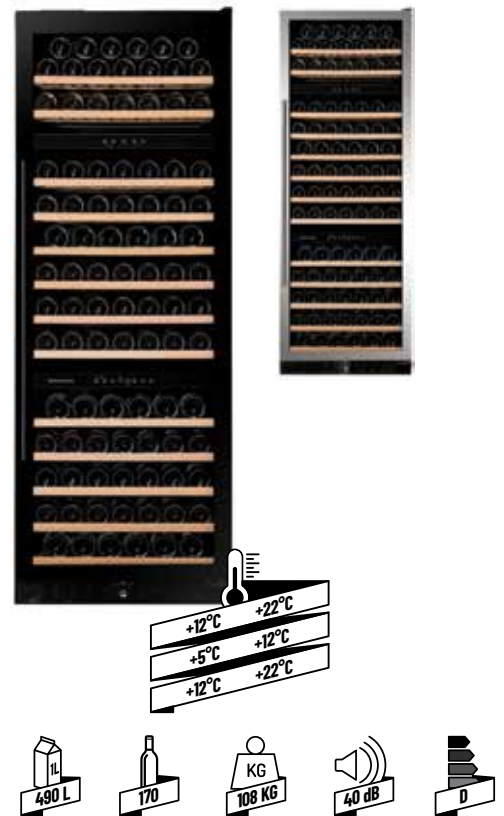

DX-170.490

A three zone, 170 bottle freestanding model from the exclusive line. Boasting an elegant exterior - the SDK model has a stainless steel handle and the black unit has black handle. The DX-170.490 is perfect for contemporary kitchens, hotels and restaurants. The bottles are supported on wooden shelves set into a stunning light blue interior. Please note that this model is suitable for freestanding or built in use.

- 170 Bordeaux bottles
- 3 temperature zones
- Colours: Black, stainless steel
- Lock
- Reversible tinted glass door (UV treated)
- Active charcoal filter
- Fan assisted cooling
- Automatic defrosting
- Wooden shelves - telescopic
- Blue interior LED light
- Dimensions: (HxWxD): 1835 x 655 x 680mm
- 3 years warranty

3
YEARS WARRANTY



Installation guide

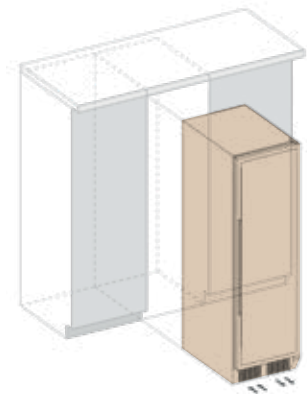



DX-181.490DBK

DX-181.490SDSK



DX-181.490

A two zone, 181 bottle freestanding model from the exclusive line. Boasting an elegant exterior - The SDSK has a stainless steel handle and the black unit has a black handle. The DX-181.490 is perfect for contemporary kitchens, hotels and restaurants. The bottles are supported on wooden shelves set into a stunning light blue interior. Please note that this model is suitable for freestanding or built in use.

- 181 Bordeaux bottles
- 2 temperature zones
- Colours: Black, stainless steel
- Reversible tinted glass door (UV treated)
- Active charcoal filter
- Automatic defrosting
- Fan assisted cooling
- Wooden shelves - telescopic
- Blue interior LED light
- Dimensions: (HxWxD): 1835 x 595 x 680mm
- 3 years warranty

3
YEARS WARRANTY



Installation guide

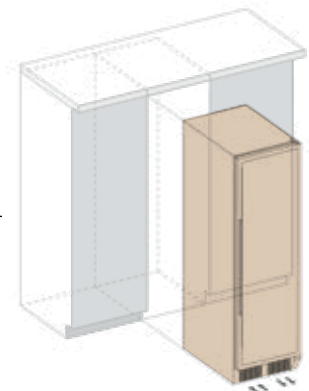



DX-194.490BK

DX-194.490SSK



DX-194.490

A single zone, 194 bottles freestanding model from Dunavox's Exclusive range. Boasting an elegant exterior - The DX-194.490 is perfect for contemporary kitchens, hotels and restaurants. The bottles are supported on wooden shelves set into a stunning light blue interior. Please note that this model is suitable for freestanding and built in use.

- 194 Bordeaux bottles
- 1 temperature zone
- Colours: Black, stainless steel
- Lock
- Reversible tinted glass door (UV treated)
- Active charcoal filter
- Automatic defrosting
- Fan assisted cooling
- Wooden shelves - telescopic
- Interior blue LED light
- Dimensions: (HxWxD): 1835 x 655 x 680mm
- 3 years warranty

3
YEARS WARRANTY



Installation guide

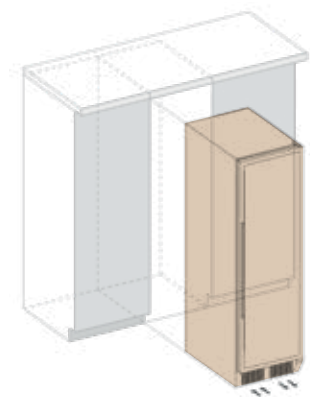



DX-198.450K



DX-198.450

A single zone, 198 bottles freestanding model from the Horeca line. Boasting an elegant exterior - the DX-198.450 is perfect for contemporary kitchens, restaurants or hotels. The bottles are supported on solid sapele shelves set into a stunning light blue interior. This unit is suitable for freestanding installation only.

- 198 Bordeaux bottles
- 1 temperature zone
- Black door frame
- Lock
- Reversible tinted glass door (UV treated)
- Active charcoal filter
- Wooden shelves
- Interior blue LED light
- Dimensions: (HxWxD): 1800 x 595 x 710mm
- 3 years warranty



DAT-6.16C

A single temperature zone thermoelectric model with an elegant black exterior with recessed handle. Thermoelectric wine coolers only suitable as a freestanding models and are not suitable for undercounter or built in use.

- 6 Bordeaux bottles
- 1 temperature zone: +8 to +18°C
- Black tinted glass
- Internal ventilation
- Metal shelves
- Blue internal LED lighting
- Dimensions: (HxWxD): 378 x 252 x 510mm
- 2 years warranty



DAT-12.33C

- 12 Bordeaux bottles
- 1 temperature zone: +12 to +18°C
- Black tinted glass door
- Metal shelves
- Blue interior LED light
- Dimensions: (HxWxD): 590 x 252 x 515mm
- 2 years warranty



DAT-12.33DC

DX-24.68DSC

A dual temperature zone thermoelectric model with an elegant black exterior with recessed handle. Thermoelectric wine coolers only suitable as a freestanding models and are not suitable for undercounter or built in use.

- 12 Bordeaux bottles
- 2 temperature zones
- Black tinted glass door
- Fan assisted cooling
- Metal shelves
- Blue interior LED light
- Dimensions: (HxWxD): 667 x 255 x 515mm
- 2 years warranty

- 24 Bordeaux bottles
- 2 temperature zones:
- Black tinted glass door
- Internal ventilation
- Metal shelves
- Blue interior LED light
- Dimensions: (HxWxD): 850 x 355 x 511mm
- 2 years warranty



DUNAVOX



www.dunavox.com



 <https://www.facebook.com/Dunavox.borhuto/>

 https://www.instagram.com/dunavox_borhuto/

 <https://www.linkedin.com/company/10000904/>